

SW485A Industrial Interface Converter Quick Installation Manual

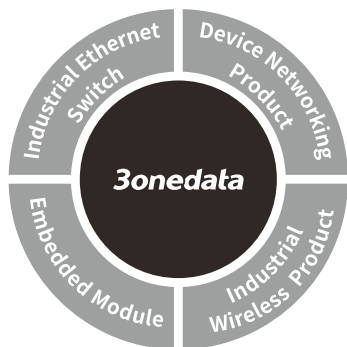

3onedata Co., Ltd.

Address: 3/B, Zone 1, Baiwangxin High Technology Industrial Park, Song Bai Road, Nanshan District, Shenzhen, 518108, China

Website: www.3onedata.com

Tel: +86 0755-26702688

Fax: +86 0755-26703485

【Package Checklist】

Please check whether the package and accessories are intact while using the interface converter for the first time.

1. Interface converter x 1
2. Warranty card
3. Quick Installation Manual
4. Certification
5. 4 pins terminal blocks

If any of these items are damaged or lost, please contact our company or dealers, we will solve it ASAP.

【Product Overview】

The product is an industrial passive pocket high sensitivity RS-232 to RS-485 interface converter. The model is SW485A (1-way RS-232 + 1-way RS-485).

【Panel Design】

➤ Front view and side view

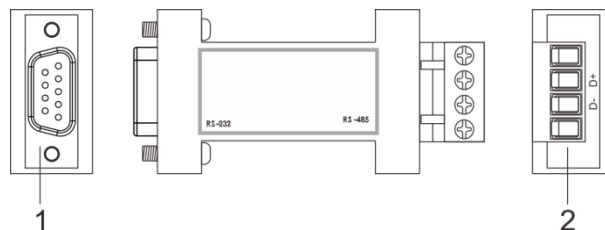

➤ Top view



1. RS-232 serial port DB9 female
2. RS-485 serial port terminal block

【Mounting Dimension】

Unit: mm

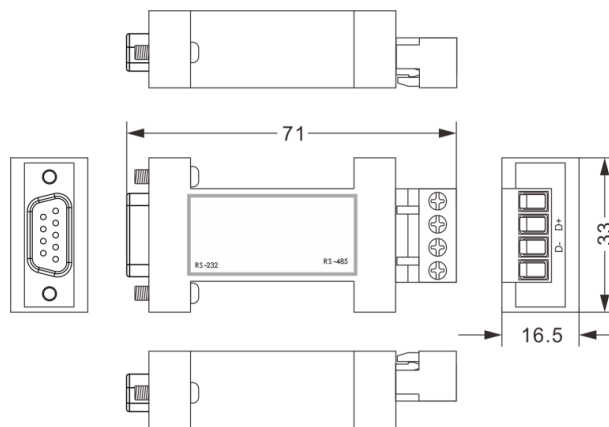

【RS-232 Serial Port】

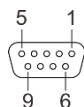

RS-232 serial port of interface converter adopts DB9 female connection mode, the pin definition as follows:

Pin NO.	2	3	5
Pin definition	TXD	RXD	GND

【RS-485 Serial Port】

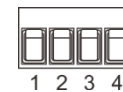

RS-485 serial port of interface converter adopts 4 pins terminal blocks, the pin definition as follows:

Pin NO.	1	2	3	4
Pin definition	GND	D-	D+	-

【Specification】

Standard	
Standard	EIA RS-232C, RS-485
Interface	
RS-232 serial port	DB9 female
RS-485 serial port	4 pins terminal blocks
Transmission rate	
Baud rate	0-115200bps
Transmission range	
RS-232	15m
RS-485	1200m
Power supply	
Input power supply	Without external power supply, powered from RS-232 serial port
Power dissipation	
Quiescent power dissipation	< 10mA
Dynamic power dissipation	< 40mA
Working environment	
Working temperature	-40~80℃
Storage temperature	-40~85℃
Working humidity	5%~95% (no condensation)